

\$1,820,000 - 2 52313 Twp Rd 24, Rural Parkland County

MLS® #E4426117

\$1,820,000

0 Bedroom, 0.00 Bathroom,
Rural on 36.00 Acres

Jackfish Lake, Rural Parkland County, AB

Welcome to Lot #1, a rare 36 +/-acre lakefront property on the shores of Jackfish Lake, just 45 minutes from downtown Edmonton and 20 minutes from Spruce Grove. This expansive lot offers an incredible nearly 1.8 km of shoreline, providing unbeatable lake access and panoramic views. The quick drop-off in water depth allows for a shorter dock, making it perfect for boating, swimming, and fishing. What sets this property apart is its nearly exclusive access to Little Jackfish Lake, as Lot 1 backs directly onto its shoreline. This unique feature offers added privacy and a second, more secluded lakefront experience. The property is surrounded by mature trees, offering both privacy and a peaceful natural setting. With power and gas at the property line. If purchased with Lot 2, the lot lines could be reconfigured with Lot 2. Experience the best of lakeside living in an unbeatable location!

Essential Information

MLS® #	E4426117
Price	\$1,820,000
Bathrooms	0.00
Acres	36.00
Type	Rural
Sub-Type	Vacant Lot/Land

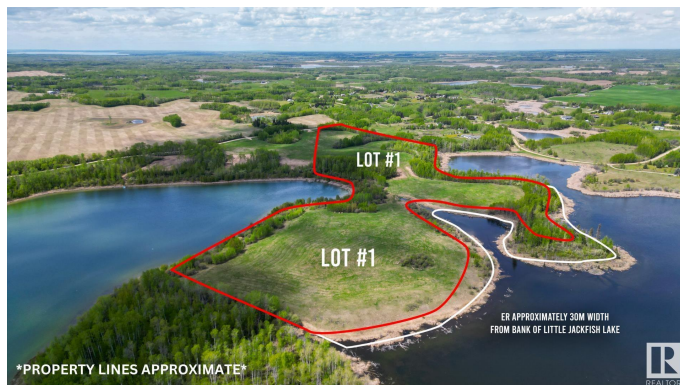

Status Active

Community Information

Address 2 52313 Twp Rd 24
Area Rural Parkland County
Subdivision Jackfish Lake
City Rural Parkland County
County ALBERTA
Province AB
Postal Code T0E 0H0

Exterior

Exterior Features Boating, Lake Access Property, Lake View, Park/Reserve, Private Setting, Recreation Use, River View, Treed Lot, Waterfront Property

Additional Information

Date Listed March 17th, 2025
Days on Market 56
Zoning Zone 97

DATA IS DEEMED RELIABLE BUT IS NOT GUARANTEED ACCURATE BY THE REALTORS® ASSOCIATION OF EDMONTON. COPYRIGHT 2025 BY THE REALTORS® ASSOCIATION OF EDMONTON. ALL RIGHTS RESERVED.Trademarks are owned or controlled by the Canadian Real Estate Association (CREA) and identify real estate professionals who are members of CREA (REALTOR®, REALTORS®) and/or the quality of services they provide (MLS®, Multiple Listing Service®)
Listing information last updated on May 12th, 2025 at 1:47am MDT